

The Thomas Companies LLC offers a specialized service to relocate maintenance parts storage from conventional shelving into high density drawer cabinets. We offer this service on a per SKU (stock keeping unit) basis which makes estimating the project cost easy and the final invoice amount accurate.



We only invoice for the actual quantity of SKU's relocated . Our basic service includes the relocation on the inventory from the existing shelf , bin or rack into a drawer cabinet compartment. The move is recorded and its new location reported to the end user to avoid location confusion.

Additional services such as inventory counts, labeling and sortation, shelving dismantling and cabinet installation are available as required.



The Grainger client wanted to solve an number of problems they were having with their existing maintenance parts department.

The existing area was on and below a modular mezzanine.

The solutions they wanted to solve were ....

1. Relocate existing inventory from shelving to Vidmar drawer cabinets.
2. Inspect inventory during the relocation and eliminating defunct material.
3. Dismantle the existing shelving and prepare for disposal.
4. clear out the lower level of the mezzanine to enable them to paint the floor and underside of the deck to better illuminate the stock room.
5. produce a cabinet layout and locator system .
6. Take an inventory count during the relocation.
7. Deliver a spreadsheet that they could download into their ICS.

PICTURES # 1 , 2 AND 3 WAS THE EXISTING AREA.



WE PRODUCED THIS LAYOUT TO DEFINE WHERE THE CABINETS WOULD FINALLY BE LOCATED AND ESTABLISHED THE LOCATOR SYSTEM.

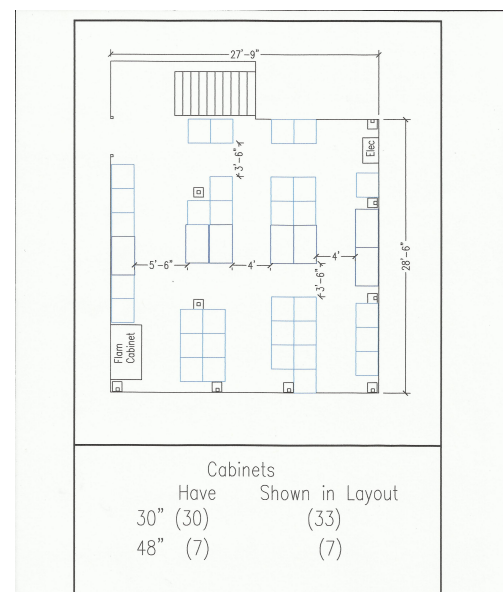

PICTURE #4 IS THE TEMPORARY SITE FOR THE CABINETS .  
WE UNLOADED THE SHELVING INTO THESE CABINETS.  
THIS ALLOWED THE CUSTOMER TO PAINT THE FLOOR AND UNDERSIDE OF THE MEZZANINE.  
WE ALSO SEPARATED OUT DEFUNCT INVENTORY , TOOK AN INVENTORY COUNT , PRODUCED AND ATTACHED THE LABELS AND SHARED THE SPREADSHEET WITH GRAINGER SO THAT THEY COULD USE THIS DATE IN THEIR KEEP FILL PROCESS.



PICTURES # 5, 6 AND 7 SHOW THE FINAL LAYOUT WHEN WE MOVED THE FULLY LOADED CABINETS INTO PLACE.  
NOTE THE WHITE FLOOR AND CEILING!



MATERIAL , MIRS AND LABOR.....\$120,000.00 FOR 5,000 SKU.